

# Single-ended and double-ended cordsets

## WHAT IS A SINGLE-ENDED CORDSET?

A single-ended cordset is used to connect a sensor or switch with a plug connection to a terminal block.

For this purpose, the cable is provided with a socket on one side and for assembly on the other side.

## WHAT IS A DOUBLE-ENDED CORDSET?

The double-ended cordset is used to build up the sensor chain in the BERNSTEIN Smart Safety System. It is used to connect the T-adapters to each other.

For this purpose, the cable is equipped with a socket on one side and a connector on the other.



Figure 1

## 3-pole single-ended cordsets

### Product selection

No.	Article number	Designation	Cable length	Connector/ alignment	Connector 1	Connector 2	Special feature	Use for following products
	<b>3251103234</b>	AN-KAB.SH5 5M AC GERADE	5 m	Straight	F		AC/ DC BG Type	SH5
	<b>3251103236</b>	AN-KAB.SH5 5M AC WINKEL	5 m	Angle	F		AC/ DC BG Type	

### Technical data

Material core insulation/sheath	PVC (UL)
Material overmoulding/contact carrier	PUR (UL)
Material union nut	Nickel-plated brass; with screw lock
Rated voltage max.	230 V AC
Current carrying capacity max.	3 A
Temperature range	when cable is fix mounted -25°C to + 90°C when cable can be moved +5°C to + 85°C
Cable construction	3 x 0.5 mm <sup>2</sup>
Number of poles	3
Protection class in assembled state	IP67

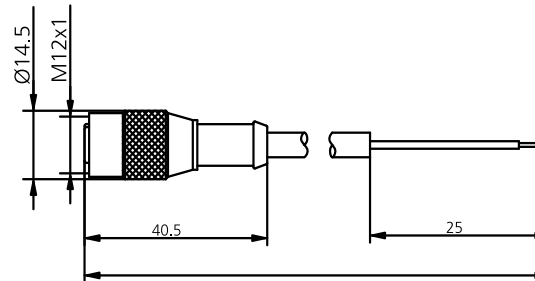

### Contact assignment AC/DC versions

- 1 = green-yellow
- 2 = black
- 3 = blue

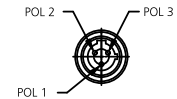

Pol Nr.	Leiter
1	GNYE (Grün/Gelb)
2	BK (Schwarz)
3	BU (Blau)



# ACCESSORIES

## 4-pole single-ended cordsets

Product selection									
No.	Article number	Designation	Cable length	Connector/alignment	Connector 1	Connector 2	Special feature	Technical data	Use for following products
3	<b>3251004310</b>	AN-KAB.SH53 4P 2M GERADE	2 m	Straight	F		M12 BG Type	1	
3	<b>3251004311</b>	AN-KAB.SH53 4P 5M GERADE	5 m	Straight	F		M12 BG Type	1	
3	<b>3251004312</b>	AN-KAB.SH53 4P 10M GERADE	10 m	Straight	F		M12 BG Type	1	
3	<b>3251004313</b>	AN-KAB.SH53 4P 2M WINKEL	2 m	Angle	F		M12 BG Type	1	- Standard and safe position switches with 4-pin M12 connector - MAK-53 M12 - Connection for Smart Safety (pos. 3 of figure 1 on page 150)
3	<b>3251004314</b>	AN-KAB.SH53 4P 5M WINKEL	5 m	Angle	F		M12 BG Type	1	
3	<b>3251004315</b>	AN-KAB.SH53 4P 10M WINKEL	10 m	Angle	F		M12 BG Type	1	
3	<b>6075689090</b>	SFW-M12C4/AW-0,5PU	0.5 m	Straight	F			2	
3	<b>6075689091</b>	SFW-M12C4/AW-2PU	2 m	Straight	F			2	
3	<b>6075689188</b>	SFW-M12C4/AW-10PU	10 m	Straight	F			2	
3	<b>6075689189</b>	SFW-M12C4/AW-20PU	20 m	Straight	F			2	

### Technical data 1

Material core insulation/sheath	PVC heat resistant UL 1731/UL 2517, black
Material overmoulding/contact carrier	APEX 7500-85/Elastollan R3000
Material union nut	Metal, CuZn, nickel-plated
Rated voltage	250 V
Current carrying capacity per pin (at 40° C)	4 A
Temperature range	when cable is fix mounted -25°C to + 105°C when cable can be moved -5°C to + 105°C
Number of poles	4
Protection class in assembled state	IP68

### Single-ended cordset

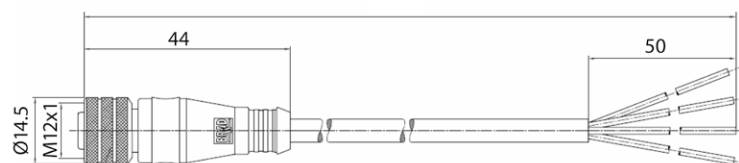

## 4-pole double-ended cordsets

### Product selection

No.	Article number	Designation	Cable length	Connector/alignment	Connector 1	Connector 2	Special feature	Technical data	Use for following products
2	<b>6075689087</b>	S1W-M12C4/AW-2PU	2 m	Straight	M	F		2	
2	<b>6075689088</b>	S1W-M12C4/AW-5PU	5 m	Straight	M	F		2	Connection of T-adapters ATS
2	<b>6075689089</b>	S1W-M12C4/AW-10PU	10 m	Straight	M	F		2	

### Technical data 2

Material core insulation/sheath	PP/PUR
Material overmoulding/contact carrier	Plastic, TPU, BK
Material union nut	Metal, CuZn, nickel-plated
Rated voltage	250 V
Current carrying capacity per pin (at 40° C)	4 A
Temperature range	when cable is fix mounted -40°C to + 90°C when cable can be moved -30°C to + 90°C
Number of poles	4
Protection class in assembled state	IP68

#### Contact assignment AC/DC versions

- 1 = brown
- 2 = white
- 3 = blue
- 4 = black

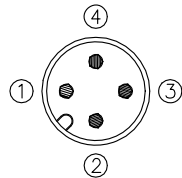

### Double-ended cordset

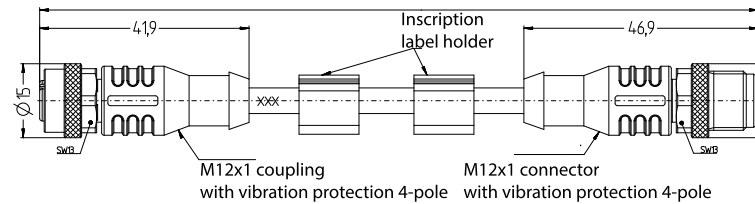

### Single-ended cordset

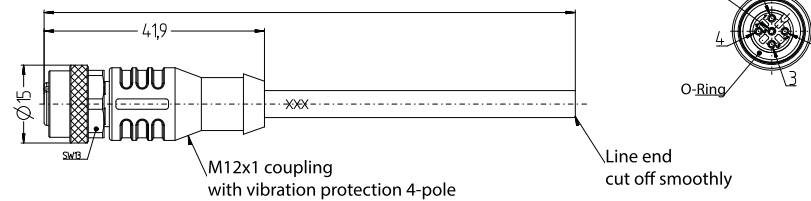

# ACCESSORIES

## 5-pole single-ended cordsets

### Product selection

No.	Article number	Designation	Cable length	Connector/alignment	Connector 1	Connector 2	Special feature	Use for following products
3	6075689092	SFW-M12B5/AW-2PU	2 m	Straight	F			- SRF-2
3	6075689093	SFW-M12B5/AW-5PU	5 m	Straight	F			- MAK 42 and 52 with M12
3	6075689183	SFW-M12B5/AW-10PU	10 m	Straight	F			- SLC with 5-pole M12 connection
3	6075689184	SFW-M12B5/AW-20PU	20 m	Straight	F			- Connection for Smart Safety (pos. 2 of figure 1 on page 150)

## 5-pole double-ended cordsets

### Product selection

No.	Article number	Designation	Cable length	Connector/alignment	Connector 1	Connector 2	Special feature	Use for following products
-	6075689003	S1W-M12B5/AW-0,3PU	0,3 m	Straight	M	F		Smart T-adapter

## Technical data

Material core insulation/sheath	PP/PUR
Material overmoulding/contact carrier	Plastic, TPU, BK
Material union nut	Metal, CuZn, nickel-plated
Rated voltage	60 V
Current carrying capacity per pin (at 40° C)	4 A
Temperature range	when cable is fix mounted -40°C to + 90°C when cable can be moved -30°C to + 90°C
Cable construction	5 x 0.34 mm <sup>2</sup>
Number of poles	5
Protection class in assembled state	IP68

### Contact assignment AC/DC versions

- 1 = brown
- 2 = white
- 3 = blue
- 4 = black
- 5 = grey

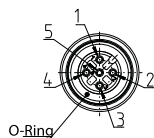

### Single-ended cordset

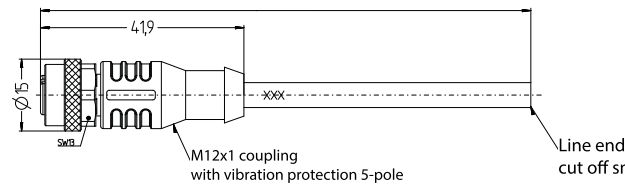

### Double-ended cordset

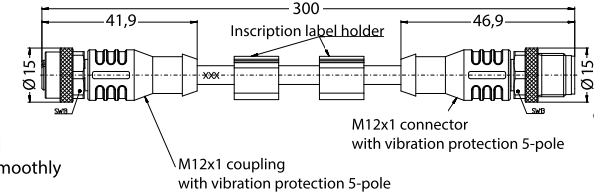

## 6-pole single-ended cordsets

### Product selection

No.	Article number	Designation	Cable length	Connector/ alignment	Connector 1	Connector 2	Special feature	Use for following products
	<b>3251006291</b>	AN-KAB.SH53 2M GERADE	2 m	Straight	F		M12 BG Type	SH53
	<b>3251006292</b>	AN-KAB.SH53 5M GERADE	5 m	Straight	F		M12 BG Type	
	<b>3251006293</b>	AN-KAB.SH53 10M GERADE	10 m	Straight	F		M12 BG Type	
	<b>3251006294</b>	AN-KAB.SH53 2M WINKEL	2 m	Angle	F		M12 BG Type	
	<b>3251006295</b>	AN-KAB.SH53 5M WINKEL	5 m	Angle	F		M12 BG Type	
	<b>3251006296</b>	AN-KAB.SH53 10M WINKEL	10 m	Angle	F		M12 BG Type	

### Technical data

Material core insulation/sheath	PVC (Ø 5.6 mm)
Material overmoulding/contact carrier	PUR/Elastollan R3000
Material union nut	Gal. Zn
Rated voltage max.	250 V AC
Current carrying capacity max.	2.5 A (bei 70°C)
Temperature range	when cable is fix mounted -40°C to + 105°C when cable can be moved -5°C to + 105°C
Cable construction	6 x 0.34 mm <sup>2</sup>
Number of poles	6
Protection class in assembled state	IP68

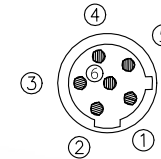
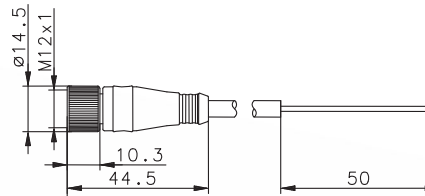

### Contact assignment AC/DC versions

- 1 = white
- 2 = brown
- 3 = green
- 4 = yellow
- 5 = grey
- 6 = pink



# ACCESSORIES

## 8-pole single-ended cordsets

Product selection								
No.	Article number	Designation	Cable length	Connector/alignment	Connector 1	Connector 2	Special feature	Use for following products
	<b>6075689185</b>	SFW-M12A8/BW-2PU	2 m	Straight	F			SRF-4 and 5, SLC, SLK
	<b>6075689186</b>	SFW-M12A8/BW-5PU	5 m	Straight	F			
	<b>6075689187</b>	SFW-M12A8/BW-10PU	10 m	Straight	F			

## 8-pole double-ended cordsets

Product selection								
No.	Article number	Designation	Cable length	Connector/alignment	Connector 1	Connector 2	Special feature	Use for following products
1	<b>6075689085</b>	S1W-M12A8/BW-1PU	1 m	Straight	M	F		Extension between SRF-4/5 and T-adapter
1	<b>6075689086</b>	S1W-M12A8/BW-2PU	2 m	Straight	M	F		

## Technical data

Material core insulation/sheath	PP/PUR
Material overmoulding/contact carrier	Plastic, TPU, BK
Material union nut	Metal, CuZn, nickel-plated
Rated voltage	30 V
Current carrying capacity per pin (at 40° C)	2 A
Temperature range	when cable is fix mounted -40°C to + 90°C when cable can be moved -30°C to + 90°C
Cable construction	8 x 0.25 mm <sup>2</sup>
Number of poles	8
Protection class in assembled state	IP68

### Single-ended cordset

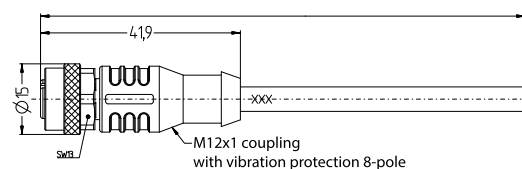

### Double-ended cordset

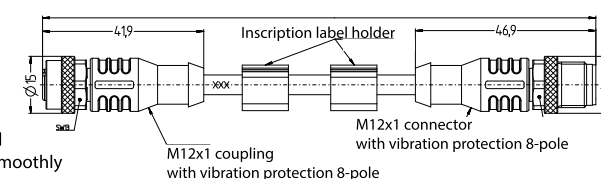

### Contact assignment AC/DC versions

- 1 = white
- 2 = brown
- 3 = green
- 4 = yellow
- 5 = grey
- 6 = pink
- 7 = blue
- 8 = red

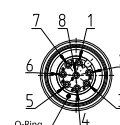

## Further accessories

### T-adapter for series connection of the sensors

No.	Article number	Designation
4	6075989082	ATS-M12/4-M12/8

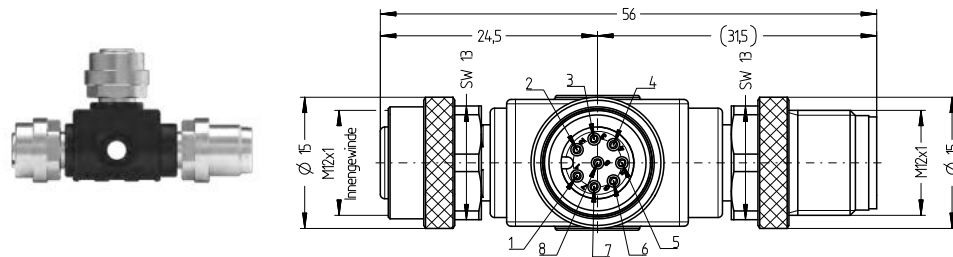

### Termination plug M12

No.	Article number	Designation
6	6075689084	AEP-M12/4

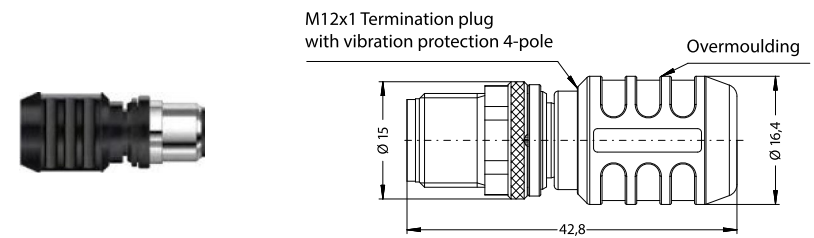

### T-adapter for connection IO-Link and reset button

No.	Article number	Designation
5	6075989083	ATD-M12/8-M12/4

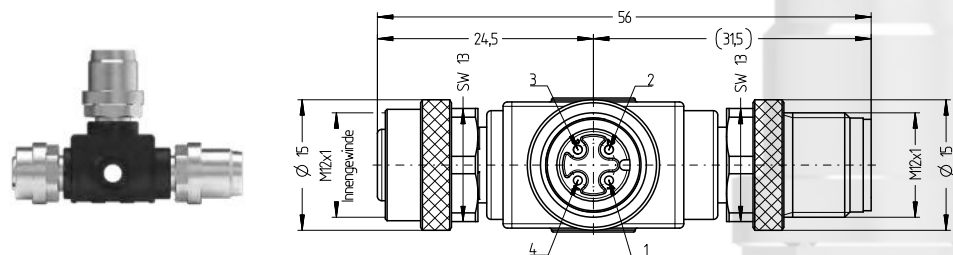

### Fixing clip for T-adapter

No.	Article number	Designation
	6075689127	AT-CLIP-M12

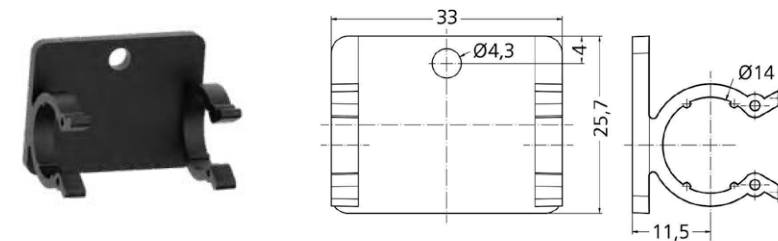



# Accessories

## Screw-in LED



### MANY BENEFITS AT A GLANCE

- Suitable for all M20x1.5 threads
- Indication of guard locking, emergency stop status and much more
- Directly controllable via the contacts
- Supply voltage 24V DC

### Technical data

#### Mechanical data

Enclosure lower part	Plastic PC/ABS black
Enclosure upper part	Plastic Lexan, PC transparent
O ring	NBR (nitrile rubber)

#### Electrical data

Rated operating voltage	$U_e$	24V ± 20%
Rated operational current	$I_e$	24 mA

#### Wiring Diagram

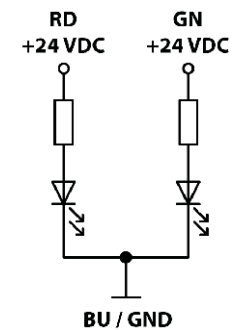

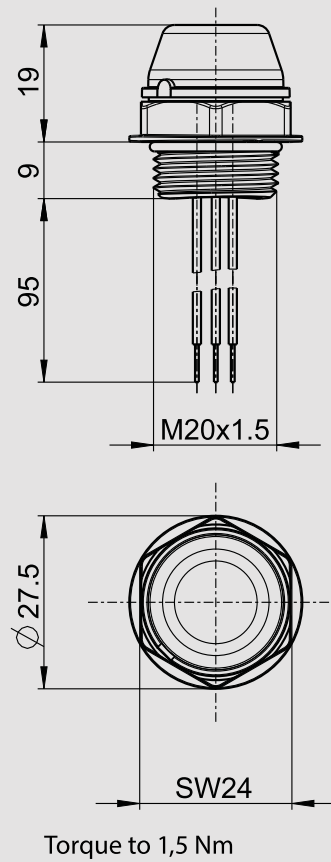

Screw-in LED

Article number	Designation	Colours
6519125001	L20-RD/GN	Red/Green

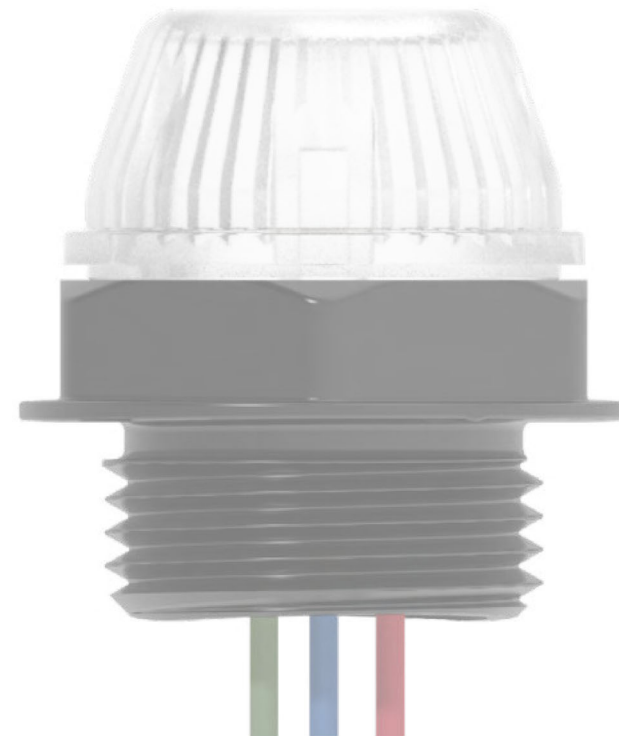
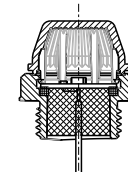

# One-way screws

## WHY ONE-WAY SCREWS?

In order to reduce the possibility of manipulation of safety switches and, if necessary, their actuators, DIN EN ISO 14119 allows the fastening of switches and actuators with one-way screws.

### One-way screw M4X8

Article number	Designation	Dimensions	Packaging unit	Material
6054999015	EINWEGSCHR.M4X8	M4 x 8 mm	2	Stainless steel



#### Can be used for:

3112850345 M2-Actuator  
 3112850340 M3-Actuator  
 3911452116 SK-BET.M4 KPL. M.KAP.  
 3911452159 SK-BET. M4 KURZ KPL.  
 3911451949 SK-BET.M.LG-BUCHSE  
 3911451914 SK-BET.KPL.M.KAP.  
 6016999190 M1-Actuator  
 6016999191 M2-Actuator  
 6016999192 M3-Actuator  
 6016999193 M4-Actuator  
 6016999194 M5-Actuator  
 TK-42  
 MAK42

### One-way screw M4X16

Article number	Designation	Dimensions	Packaging unit	Material
6054999016	EINWEGSCHR.M4X16	M4 x 16 mm	2	Stainless steel



#### Can be used for:

TK-52  
 3911702228 A1-Actuator  
 3911702234 A7-Actuator  
 3911742390 ACS-1-Actuator  
 SRF and SRF Actuator  
 I49  
 M49  
 MAK52

### One-way screw M5X10

Article number	Designation	Dimensions	Packaging unit	Material
6054999017	EINWEGSCHR.M5X10	M5 x 10 mm	2	Stainless steel



#### Can be used for:

3911452058 MRU-Actuator  
 3911702229 A2-Actuator  
 3911702230 A3-Actuator  
 3911702231 A4-Actuator  
 3911742392 ACC-1-Actuator  
 3911742398 ACR-1-Actuator  
 3911742391 ACF-1-Actuator  
 6016999195 M6-Actuator

#### One-way screw M5X25

Article number	Designation	Dimensions	Packaging unit	Material
6054999018	EINWEGSCHR.M5X25	M5 x 25 mm	2	Stainless steel



#### Can be used for:

SK  
SKC

#### One-way screw M5X40

Article number	Designation	Dimensions	Packaging unit	Material
6054999021	EINWEGSCHR.M5X40	M5 x 40 mm	4	Stainless steel



#### Can be used for:

IN73  
MN78

#### One-way screw M5X25

Article number	Designation	Dimensions	Packaging unit	Material
6054999019	EINWEGSCHR.M5X25 DK8,5	M5 x 25 mm	2	Stainless steel



#### Can be used for:

I88  
IN62  
IN65

#### One-way screw M5X40

Article number	Designation	Dimensions	Packaging unit	Material
6054999022	EINWEGSCHR.M5X40 DK8,5	M5 x 40 mm edited	4	Stainless steel



#### Can be used for:

SLC

#### One-way screw M5X30

Article number	Designation	Dimensions	Packaging unit	Material
6054999020	EINWEGSCHR.M5X30 DK8,5	M5 x 30 mm	2	Stainless steel



#### Can be used for:

SKT  
SKI

## Built-in connector

### FOR WHICH SWITCHES ARE THE CONNECTORS SUITABLE?

The M12 flush-type connectors can be installed in an M20 thread of the position and safety switches.

For use in conjunction with the SMART T-adapter 6075689191 SEU-1/0-T45-C-X-AB, the panel connector 6079000002 must be used.

#### Connector 4-pole

##### Article number

6079000001

##### Designation

STECKER 4P M12/M20 A-COD

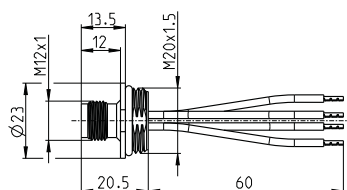

1	BN
2	WH
3	BU
4	BK

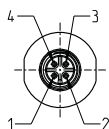

#### Connector 5-pole

##### Article number

6079000002

##### Designation

STECKER 5P M12/M20 A-COD

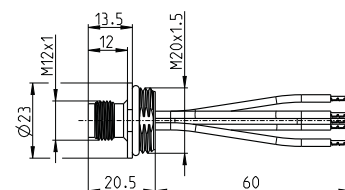

1	BN
2	WH
3	BU
4	BK
5	GY

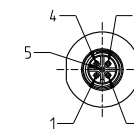

#### Technical data

Rated voltage	250 V
Rated current (40°C)	4 A (3 A UL)
Enclosure, contact body	PA
Contact, surface	CuZn, Au
Mechanical life	> 50 Mating cycles
Stranded conductor with ferrule	4 x H05V2-K, 0.5 mm <sup>2</sup> , PVC
Tightening torque (flange plug – switch enclosure)	1 Nm
Protection class	IP67*

\* Only with correspondingly installed flange plug and with corresponding and mounted cable coupling.

#### Technical data

Rated voltage	60 V
Rated current (40 °C)	4 A (3 A UL)
Enclosure, contact body	PA
Contact, surface	CuZn, Au
Mechanical life	> 50 Mating cycles
Stranded conductor with ferrule	5 x H05V2-K, 0.5 mm <sup>2</sup> , PVC
Tightening torque (flange plug – switch enclosure)	1 Nm
Protection class	IP67*

\* Only with correspondingly installed flange plug and with corresponding and mounted cable coupling.

\*\* Attention: For technical reasons, the 5-pole version of the built-in plug has a rated voltage of 60 V only. This means that if this built-in plug is installed in a switch that is designed for voltages higher than 60 V, the rated voltage of the switch with the 5-pole plug is reduced to 60 V! It is not permissible to operate the switch with voltages higher than 60 V.