



**CC-10**  
**Compact Control Enclosures**

# Application fields and characteristics



BERNSTEIN compact control enclosures from the CC-10 product line are ideal for use as remote operator control stations. Made from die-cast aluminium these enclosures are available from stock in standard sizes. All sizes have an earthing point in the lid and the base for protective earth connection. The captive lid screws are stainless steel and are concealed by push fit corner pieces. The anodised aluminium frontplate (ordered separately) is fixed internally and sealed to the frame with a neoprene gasket maintaining an IP 65 rating for the complete enclosure.

Attachment points provided inside the enclosure facilitate easy mounting of components (mounting rail, mounting plate, PCBs etc.).



## Applications

As compact control enclosures in automation, machine and installation engineering, in utility vehicles, construction or agricultural machinery, in mechanical and plant engineering. Suitable for all uses where operating and indicator controls with a high corrosion resistance and in a high protection class are to be encapsulated with a high mechanical resistance. The front plate is supplied separately, facilitating mounting of fittings. The high industrial standards achieved by BERNSTEIN, allow their enclosures to be effective in a wide range of automation control and instrumentation applications.

- Automation
- Machine and installation engineering
- Utility vehicles
- Construction machinery
- Agricultural machinery
- Mechanical engineering
- Plant engineering

# Application fields and characteristics



## Material

BERNSTEIN compact control enclosures feature a high mechanical resistance. Their excellent chemical and petro-chemical resistance makes them suitable for a wide range of applications. The enclosures are supplied with a standard coating, affording a good resistance to corrosion. This resistance can be further improved by the application of an additional protective coating. Alternatively, they can be passivated, or a special protective coating resistant to saltwater and ideal for external use, can be applied. Aluminium has excellent heat dissipation and HF radio shielding properties.

A special gasket (silicon or conductive material) can be used to further increase heat and EMC resistance.

## Technical data

### Material

- Aluminium, die-casting AlSi12 (copper)

### Gasket

- Neoprene round seal for lid and front plate

alternative:

- Silicone round seal
- Lid screws
- Stainless steel, captive screw, multi-purpose cross-head with plastic covering



### Coating

- Base RAL 7035 (light grey)
- Frame RAL 7035 (light grey)
- Frame screw coverings
- RAL 7035 (light grey)

alternative:

- Special colours according to RAL
- Special coatings

### Temperature range

- – 40 °C to + 80 °C (neoprene gasket)

alternative:

- – 50 °C to + 130 °C (silicone gasket)

### Protection class

- IP 65

# Complete enclosures and accessories



### Standard type

enclosure in RAL 7035, light grey, caps in RAL 7035 (light grey), gasket mounted, packaged.



### External hinges

for hinged mounting of enclosure frames. Opening angle of frame approx. 155°. Aluminium casting, RAL 7035. Mechanical machining required for mounting. Drill template is supplied.



### Front plate

clear-anodised aluminium, 3 mm thick, for holding operating controls or indicator panels.

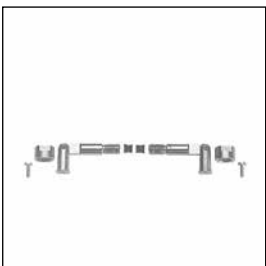

### Internal hinges

for hinge attachment of the enclosure lid. Opening angle of lid approx. 95°. Stainless steel. Mechanical machining is required for enclosure mounting.



### Mounting plates

from galvanised sheet metal (thickness: CC-270 to CC-400: 1.5 mm; CC-450 and CC-460: 2.5 mm) allows for further addition of mounted fittings.

### Customising service

The range of accessories for individual enclosures can be supplied separately or pre-assembled. The BERNSTEIN customising service provides complete mechanical machining. The fittings (terminals, cable glands or customised mounting components) are included in the service, as is the individual finishing of enclosures. The custom-made front plates (supplied separately) can also be mechanically machined and supplied with individual screen-printing or engraving.

Overview – CC-10 compact control enclosures						
Dimensions/mm	CC-10 aluminium enclosures with crimped protective frames		Frame	Base		
	L x	W x	H	Part number	Type	dc = die cast
160 x 160 x 105	127.3.0010.00	CC-270	dc	dc		
260 x 160 x 105	129.3.0010.00	CC-290	dc	dc		
200 x 230 x 125	135.3.0010.00	CC-350	dc	dc		
200 x 230 x 195	136.3.0010.00	CC-360	dc	cc		
280 x 230 x 125	137.3.0010.00	CC-370	dc	dc		
330 x 230 x 125	138.3.0010.00	CC-380	dc	dc		
330 x 230 x 195	139.3.0010.00	CC-390	dc	cc		

**160 x 160 x 105 mm**  
CC-270 aluminium control enclosure

**260 x 160 x 105 mm**  
CC-290 aluminium control enclosure

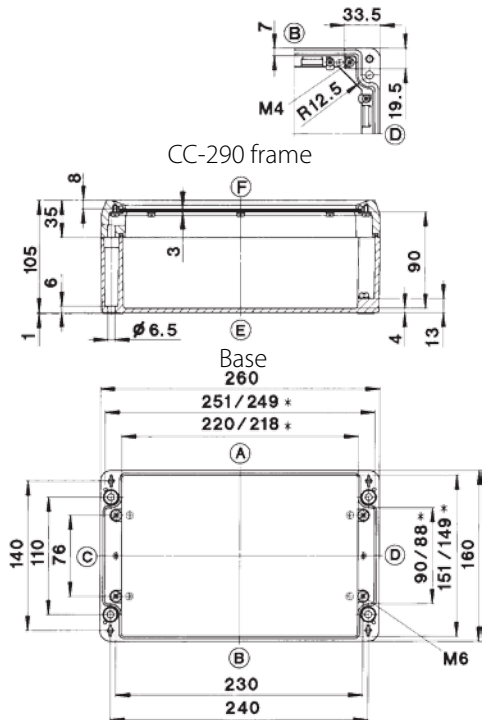
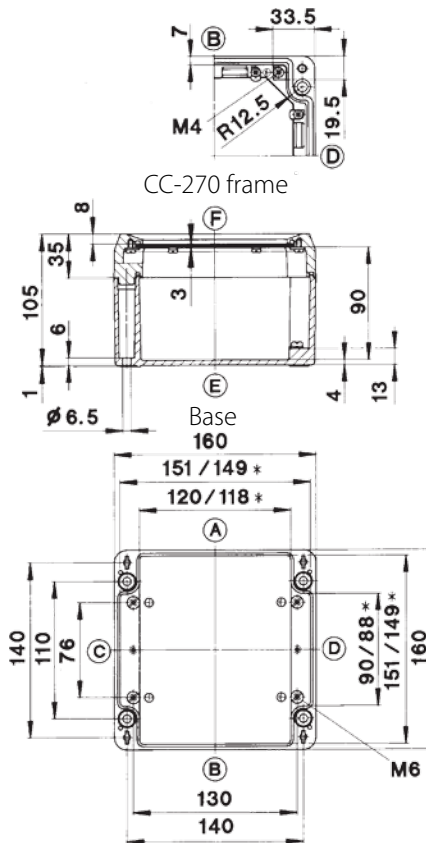

\* minimum dimensions at level of mounting plate support

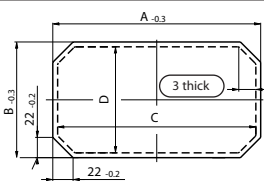
Type	CC-270
Weight (g)	1800
External dimensions (mm)	160 x 160 x 105
Complete enclosures	Part number
coated, with gasket and lid screws	127.3.0010.00
Accessories (separate or as a mounting set)	
Front plate	951.1.7580.00
Mounting plate	951.1.1490.00
External hinges**	980.1.0990.00
Internal hinges with lid guiding**	980.1.0390.00
Frame gasket for extended temp. range (piece goods)**	923.1.0060.00
Front plate gasket for extended temp. range (piece goods)**	923.1.0060.00
 <p>Front lid dimensions attachment area</p>	
** mechanical enclosure machining required	
*** piece goods	

Type	CC-270
Weight (g)	1800
External dimensions (mm)	160 x 160 x 105
Complete enclosures	Part number
coated, with gasket and lid screws	127.3.0010.00
Accessories (separate or as a mounting set)	
Front plate	951.1.7580.00
Mounting plate	951.1.1490.00
External hinges**	980.1.0990.00
Internal hinges with lid guiding**	980.1.0390.00
Frame gasket for extended temp. range (piece goods)**	923.1.0060.00
Front plate gasket for extended temp. range (piece goods)**	923.1.0060.00
A x B: 125.5 x 125.5 mm	
C x D: 115 x 115 mm	

Type	CC-290
Weight (g)	2300
External dimensions (mm)	260 x 160 x 105
Complete enclosures	Part number
coated, with gasket and lid screws	129.3.0010.00
Accessories (separate or as a mounting set)	
Front plate	951.1.7590.00
Mounting plate	951.1.0490.00
External hinges**	980.1.0990.00
Internal hinges with lid guiding**	980.1.0390.00
Frame gasket for extended temp. range (piece goods)**	923.1.0060.00
Front plate gasket for extended temp. range (piece goods)**	923.1.0060.00
A x B: 225.5 x 125.5 mm	
C x D: 215 x 115 mm	



**200 x 230 x 125 mm**  
CC-350 aluminium control enclosure

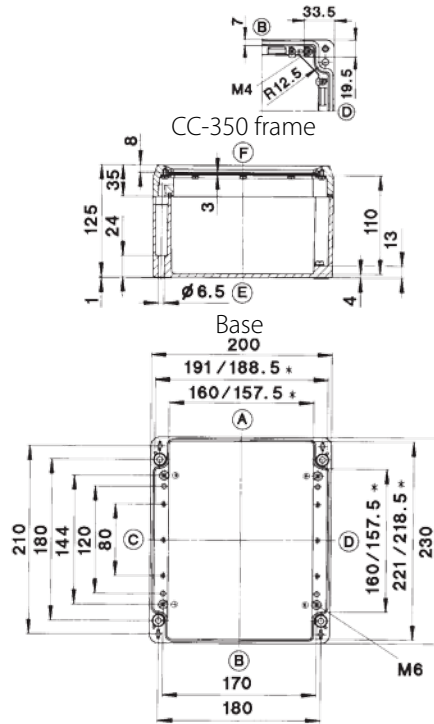

**200 x 230 x 195 mm**  
CC-360 aluminium control enclosure

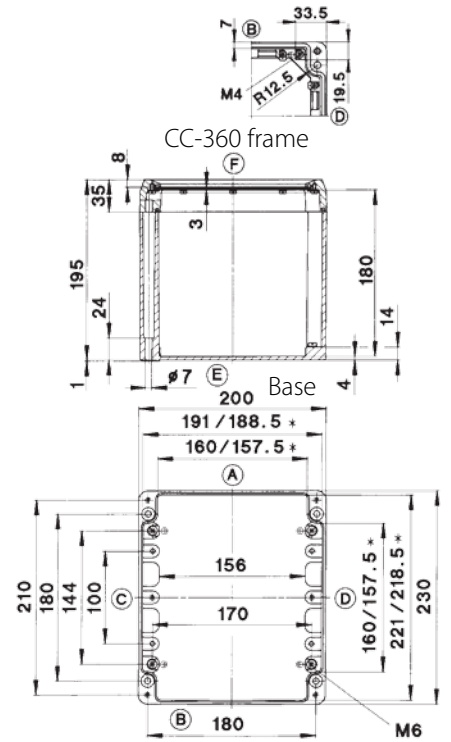

\* minimum dimensions at level of mounting plate support

Type	CC-350
Weight (g)	2800
External dimensions (mm)	200 x 230 x 125
Complete enclosures coated, with gasket and lid screws	Part number 135.3.0010.00
Accessories (separate or as a mounting set)	
Front plate	951.1.7610.00
Mounting plate	951.1.0150.00
External hinges**	980.1.0990.00
Internal hinges with lid guiding**	980.1.0390.00
Frame gasket for extended temp. range (piece goods)**	923.1.0060.00
Front plate gasket for extended temp. range (piece goods)***	923.1.0060.00
<p>Front lid dimensions attachment area</p>	<p>A x B: 165.5 x 195.5 mm C x D: 155 x 185 mm</p>
** mechanical enclosure machining required	
*** piece goods	

Type	CC-360
Weight (g)	4100
External dimensions (mm)	200 x 230 x 195
Complete enclosures coated, with gasket and lid screws	Part number 136.3.0010.00
Accessories (separate or as a mounting set)	
Front plate	951.1.7610.00
Mounting plate	951.1.0150.00
External hinges**	980.1.0990.00
Internal hinges with lid guiding**	980.1.0390.00
Frame gasket for extended temp. range (piece goods)**	923.1.0060.00
Front plate gasket for extended temp. range (piece goods)***	923.1.0060.00
<p>Front lid dimensions attachment area</p>	<p>A x B: 165.5 x 195.5 mm C x D: 155 x 185 mm</p>
** mechanical enclosure machining required	
*** piece goods	

Type	CC-360
Weight (g)	4100
External dimensions (mm)	200 x 230 x 195
Complete enclosures coated, with gasket and lid screws	Part number 136.3.0010.00
Accessories (separate or as a mounting set)	
Front plate	951.1.7610.00
Mounting plate	951.1.0150.00
External hinges**	980.1.0990.00
Internal hinges with lid guiding**	980.1.0390.00
Frame gasket for extended temp. range (piece goods)**	923.1.0060.00
Front plate gasket for extended temp. range (piece goods)***	923.1.0060.00
<p>Front lid dimensions attachment area</p>	<p>A x B: 165.5 x 195.5 mm C x D: 155 x 185 mm</p>
** mechanical enclosure machining required	
*** piece goods	



### 280 x 230 x 125 mm

CC-370 aluminium control enclosure

### 330 x 230 x 125 mm

CC-380 aluminium control enclosure

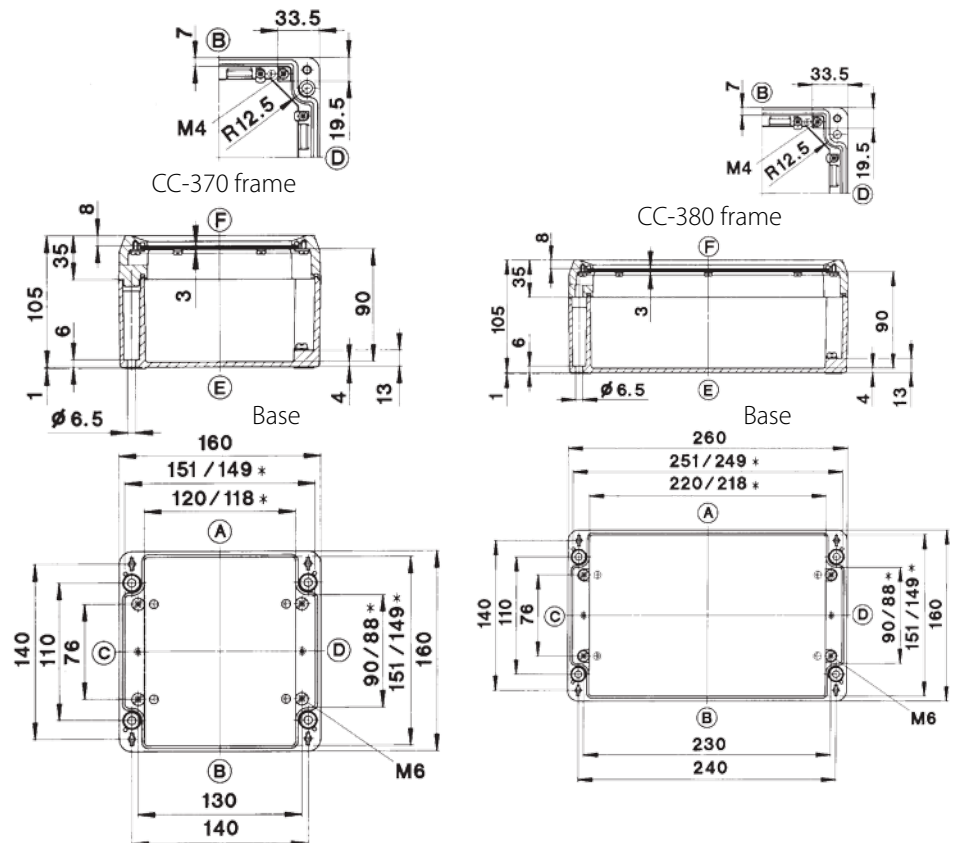

\* minimum dimensions at level of mounting plate support

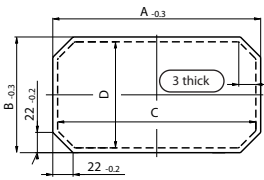
Type	
Weight	(g)
External dimensions	(mm)
Complete enclosures coated, with gasket and lid screws	
Accessories (separate or as a mounting set)	
Front plate	
Mounting plate	
External hinges**	
Internal hinges with lid guiding**	
Frame gasket for extended temp. range (piece goods)**	
Front plate gasket for extended temp. range (piece goods)***	
 <p>Front lid dimensions attachment area</p>	
** mechanical enclosure machining required	
*** piece goods	

CC-370	
Weight	3400
External dimensions	280 x 230 x 125
Part number	137.3.0010.00
Front plate	951.1.7620.00
Mounting plate	951.1.0160.00
External hinges**	980.1.0990.00
Internal hinges with lid guiding**	980.1.0390.00
Frame gasket for extended temp. range (piece goods)**	923.1.0060.00
Front plate gasket for extended temp. range (piece goods)***	923.1.0060.00
A x B: 245.5 x 195.5 mm	
C x D: 235 x 185 mm	

CC-380	
Weight	3400
External dimensions	330 x 230 x 125
Part number	138.3.0010.00
Front plate	951.1.7630.00
Mounting plate	951.1.0170.00
External hinges**	980.1.0990.00
Internal hinges with lid guiding**	980.1.0390.00
Frame gasket for extended temp. range (piece goods)**	923.1.0060.00
Front plate gasket for extended temp. range (piece goods)***	923.1.0060.00
A x B: 295.5 x 195.5 mm	
C x D: 285 x 185 mm	

## 330 x 230 x 195 mm CC-390 aluminium control enclosure

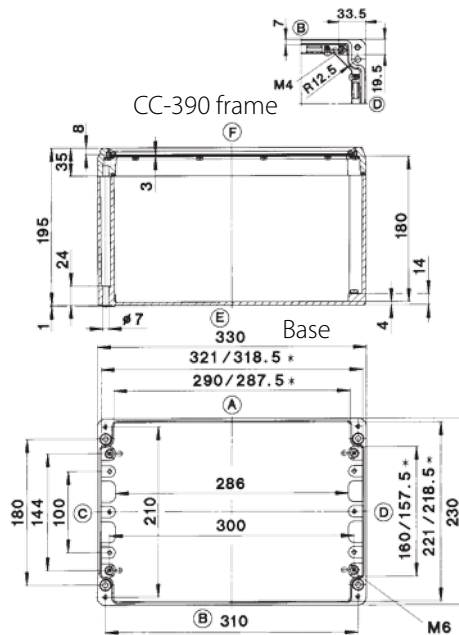

Type	CC-390
Weight (g)	5300
External dimensions (mm)	330 x 230 x 195
Complete enclosures coated, with gasket and lid screws	Part number
Accessories (separate or as a mounting set)	139.3.0010.00
Front plate	951.1.7630.00
Mounting plate	951.1.0170.00
External hinges**	980.1.0990.00
Internal hinges with lid guiding**	980.1.0390.00
Frame gasket for extended temp. range (piece goods)**	923.1.0060.00
Front plate gasket for extended temp. range (piece goods)***	923.1.0060.00
<p>Front lid dimensions attachment area</p>	<p>A x B: 295.5 x 195.5 mm C x D: 285 x 185 mm</p>
** mechanical enclosure machining required	
*** piece goods	

# More enclosures from Bernstein

## IP68 Utility Enclosures



Impact Series



Premium Series



Accessories



## Bespoke Enclosures

Enclosures designed and produced to your specification. Call or email to discuss your requirements.

**01922 715102**  
[sales@bernstein-ltd.co.uk](mailto:sales@bernstein-ltd.co.uk)

## Industrial Enclosures



CA  
Aluminium enclosures



CP  
Polyester (GRP) Grey & Black enclosures



CT  
Polycarbonate & ABS enclosures



Stainless Steel enclosures



General purpose painted mild steel enclosures

## Suspension Systems



CS-3000  
Medium load aluminium suspension system



CS-480 & CS-600  
Stainless steel suspension system



CS-2000 80  
Heavy load steel suspension system



CS-2000 SL 45x60  
Lightweight aluminium suspension system

## Control Enclosures



CC-4000  
Modular control enclosures



CC-4000 SL  
Slimline modular control enclosures



WS-6000  
Compact industrial workstation



CC-480/600NR  
Stainless steel control enclosures



CC-10  
Aluminium compact control enclosures



**CC-5000 next**  
Aluminium Control Enclosure



*Integra Premium Polycarbonate enclosures*



**Switch systems –  
Economy meets safety**



**Sensor systems –  
Compact intelligence**



**Enclosure systems –  
Function and design**

[www.bernstein-ltd.co.uk](http://www.bernstein-ltd.co.uk)

**Bernstein Ltd**  
Unit One, Tintagel Way,  
Westgate, Aldridge,  
West Midlands WS9 8ER

**Tel** 01922 744999  
**Fax** 01922 457555  
[sales@bernstein-ltd.co.uk](mailto:sales@bernstein-ltd.co.uk)