

# Inductive Sensors **SIB-Sensors**

**NEW**



## **Wide range of applications for inductive sensors in safety-critical applications**

Inductive sensors can be used in a wide range of applications, from escalators, where they are used to monitor the main drive chain and the handrail, to lifts, loading cranes and stationary presses. In combination with a suitable safety evaluation system, they offer a reliable solution for safely detecting the position of metal objects throughout the mechanical engineering sector.

# Inductive Sensors SIB-Sensors

**NEW**



## Product features

- Can be used in safety-relevant applications up to PL d/SIL 2 with suitable evaluation
- Two antivalent output signals (NO and NC)
- Reduces the wiring effort
- Low acquisition costs
- Overall system becomes simpler and less complex

## Technical data

### Electrical data

Rated operating voltage range	$U_b$	8 – 30 V DC (PELV / SELV-power supply unit)
Rated operating current	$I_e$	200 mA
Max. switching voltage	$f$	200 Hz
Short circuit-protection		cyclic

### Mechanical data

Material	Brass, nickel plated
Ambient temperature	-30 °C to +80 °C
Protection class	IP67 (only in fully locked position with it's plugs)

### Safety data at 60°C

Up to PL	d	acc. to DIN EN ISO 13849-1
Category	2	
PFH <sub>b</sub>	1,46 x 10 <sup>-8</sup> 1/h	acc. to DIN EN 62061
SIL CL	2	
MTTF d	1990 years	
Service life	20 years	

The inductive proximity switch may only be used in conjunction with a safety controller, for example a safety PLC, which recognises a sensor error before the next request to the safety function.

### SIB M12

#### Wiring diagram

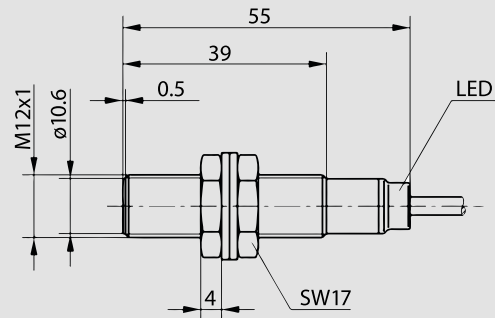
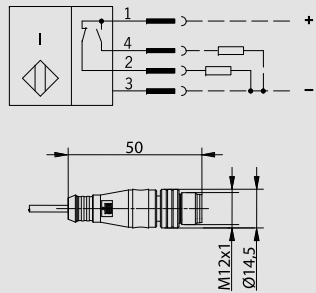

### SIB M18

#### Wiring diagram

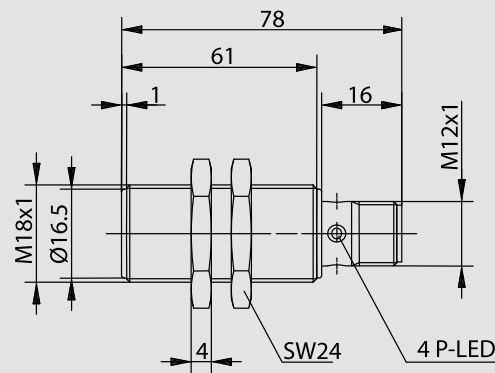
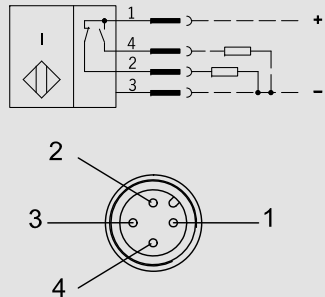

#### Product range

Article number	Designation	Connection
6502803003	SIB-M12PA/002-KL0,2S12	Cable 0,2 m , PUR-Coating, with connector M12
6502805003	SIB-M18PA/008-KLS12	Connector M12x1

